

# U.S. PROVINCIAL SHRINE CAPITAL CAMPAIGN

By God's grace and your generosity, we are building a spiritual stronghold for the Institute in the USA. Please consider helping us build the Institute's Provincial Headquarters campus in the United States. Here is the latest work being done this week:

## PROVINCIAL SHRINE:

### *Building Commission Meeting*



This past week, the Institute's Provincial Superior, Canon Matthew Talarico, along with the Project manager, Canon Matthew Weaver and the Shrine's architecture team met with the Chicago Building Commission for approval on the final building plans for the Shrine of Christ the King.

Just weeks before going to permit, everything is in place!

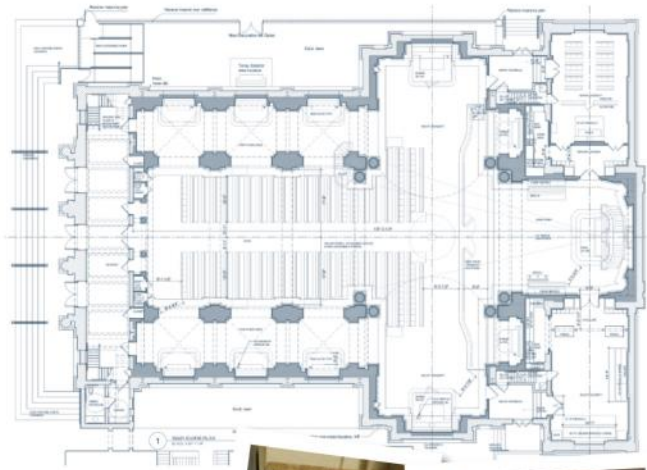

## PROVINCIAL HEADQUARTERS:

### *New Electrical Work*



*Before and After!*

To find out how you can help by donating to the Institute of Christ the King Sovereign Priest, Email our Project Manager, Rev. Canon Matthew Weaver, at [info@institute-christ-king.org](mailto:info@institute-christ-king.org)



INSTITUTE OF CHRIST THE KING  
SOVEREIGN PRIEST

[institute-christ-king.org](http://institute-christ-king.org) (773)363-7409